

CLOSURE NOTES

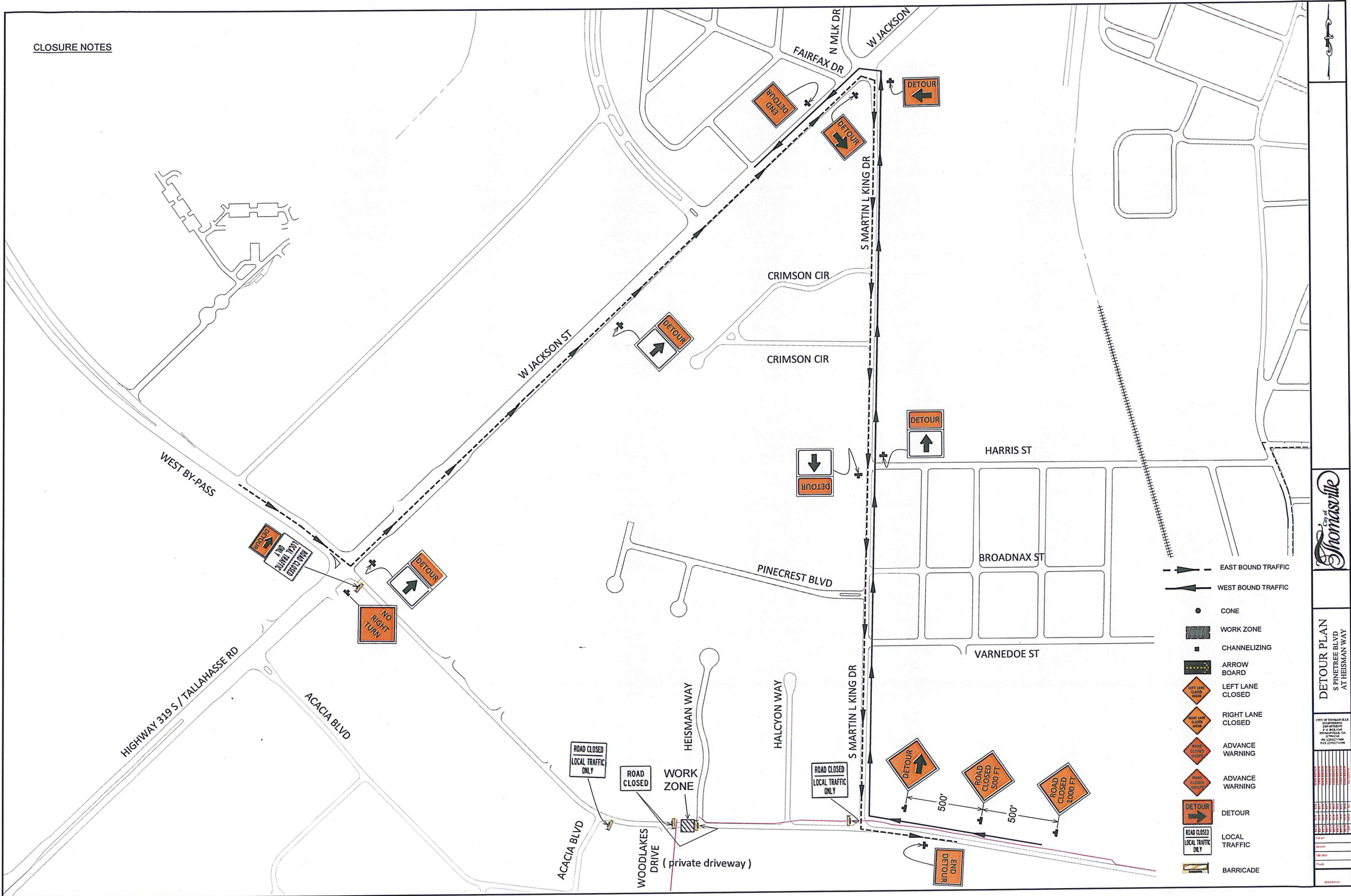

DETOUR PLAN
S PINETREE BLVD
AT HEISMAN WAY

CITY OF THOMASVILLE
THOMASVILLE, GA 31784
PHONE: 910.424.1234
FAX: 910.424.1234

NO.	DESCRIPTION	DATE	STATUS
1	DETOUR PLAN	05/15/2018	APPROVED
2	DETOUR PLAN	05/15/2018	APPROVED
3	DETOUR PLAN	05/15/2018	APPROVED
4	DETOUR PLAN	05/15/2018	APPROVED
5	DETOUR PLAN	05/15/2018	APPROVED
6	DETOUR PLAN	05/15/2018	APPROVED
7	DETOUR PLAN	05/15/2018	APPROVED
8	DETOUR PLAN	05/15/2018	APPROVED
9	DETOUR PLAN	05/15/2018	APPROVED
10	DETOUR PLAN	05/15/2018	APPROVED
11	DETOUR PLAN	05/15/2018	APPROVED
12	DETOUR PLAN	05/15/2018	APPROVED
13	DETOUR PLAN	05/15/2018	APPROVED
14	DETOUR PLAN	05/15/2018	APPROVED
15	DETOUR PLAN	05/15/2018	APPROVED
16	DETOUR PLAN	05/15/2018	APPROVED
17	DETOUR PLAN	05/15/2018	APPROVED
18	DETOUR PLAN	05/15/2018	APPROVED
19	DETOUR PLAN	05/15/2018	APPROVED
20	DETOUR PLAN	05/15/2018	APPROVED

DATE: 05/15/2018